

# TAURUS III recycling bin

Taurus III has a Mild steel body with Powder Coated finish in Zinc rich primer. The bin has a top opening to empty it. The bin comes in dual colour with SS 316 accessories. Three inner Galvanised steel containers are present to hold the waste bag.

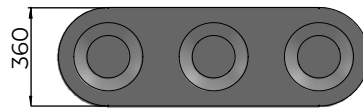

## DIMENSIONS

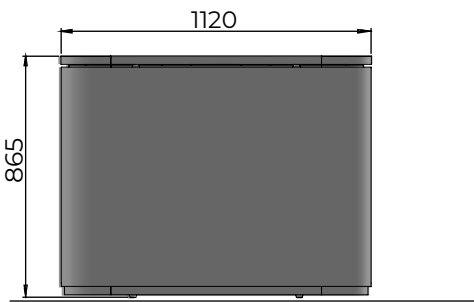

Free standing / Surface Fixed  
3 x 45 L

## MATERIAL AND FINISH

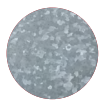

**BODY, LID**  
Steel  
Powder Coating

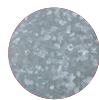

**LINER**  
Steel  
Galvanised

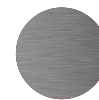

**ACCESSORIES**  
Stainless Steel

## STANDARD COLOURS



RAL 1013 Pearl White



RAL 7016 Anthracite Grey



RAL 9005 Jet Black

## FINISH - POWDER COATING

- Semi - gloss
- Matt
- Texture

## ADD-ONS

Signage / Logo

Lock (SS 316)

[Standard Graphics](#) (click to view)

## WARRANTY

[Warranty document](#) (click to view)

## CERTIFICATIONS

