

# LAKSHA III recycling bin

Laksha III has a Mild steel body with Powder Coated finish in Zinc rich primer. It has a top opening for emptying the bin. It has Iroko wood cladded on the body with stain dark walnut finish. Custom Logo can be Wood engraved. It also contains three inner Galvanised steel containers to hold waste bags.

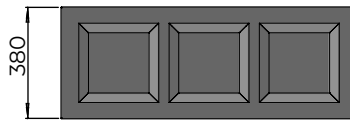

## DIMENSIONS

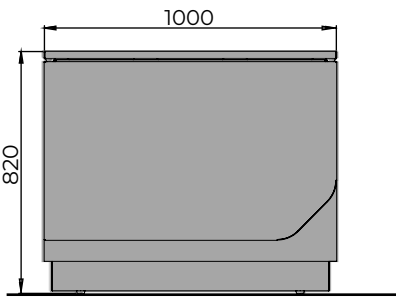

Free standing / Surface Fixed  
3 x 40 L



SCAN TO  
VIEW IN AR

## MATERIAL AND FINISH

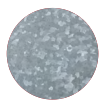

**BODY, LID**  
Steel  
Powder Coating



**BODY**  
Iroko Wood  
PU Stain

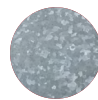

**LINER**  
Steel  
Galvanised

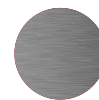

**ACCESSORIES**  
Stainless Steel

## STANDARD COLOURS



RAL 1013 Pearl White



RAL 7016 Anthracite Grey



RAL 9005 Jet Black

## FINISH - POWDER COATING

- Semi - gloss
- Matt
- Texture

## ADD-ONS

Signage / Logo

Lock (SS 316)

[Standard Graphics \(click to view\)](#)

## WARRANTY

[Warranty document \(click to view\)](#)

## CERTIFICATIONS

