

BODY
 MATERIAL : MILD STEEL
 FINISHING :ZINC RICH PRIMER AND POWDER COATING
 (SEMIGLOSSY/MATT/TEXTURED)
 COLOUR - AS PER REQUIREMENT.

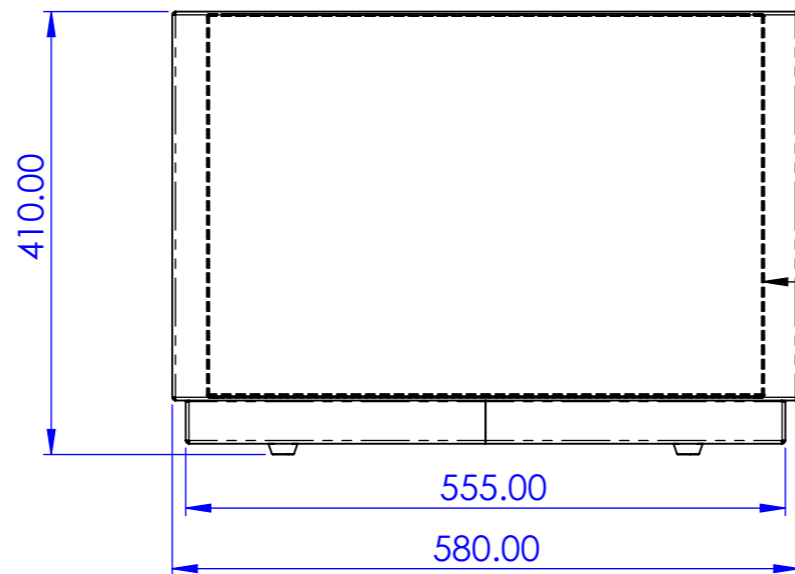

LINER
 MATERIAL : GI

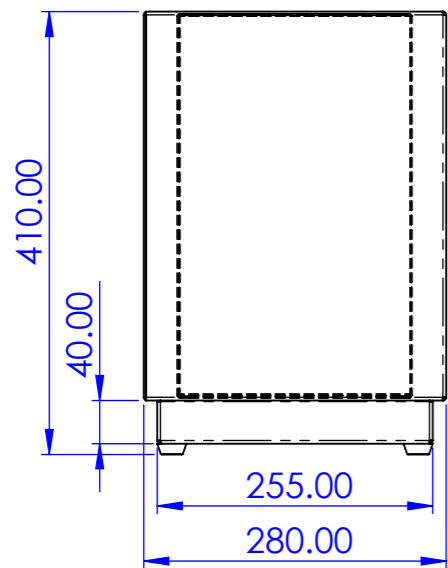
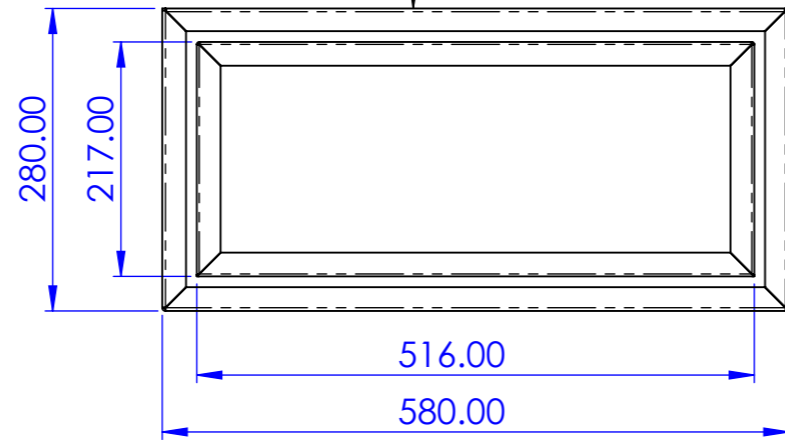

MODEL : KAVA II PLANTER (L-580 X W-280 XH-410mm)
 MATERIAL : MILD STEEL.
 FINISHING :ZINC RICH PRIMER AND POWDER COATING.
 (SEMIGLOSSY/MATT/TEXTURED)
 COLOUR - AS PER REQUIREMENT.
 LINER CAPACITY : 40 Ltr
 INSTALLATION : FREE STANDING/SURFACE FIXED.

SPECIFIED DIMENSIONS ARE IN MILLIMETERS

NOTE:Please note that by using this drawing in any format,you are accepting that Bluestream owns the copyright.You are licensed to use this drawing for any product on which Bluestreamme are tendering, and you should not knowingly allow others to copy this drawing.Obtain appropriate licenses from Bluestream if you intend to use the intellectual property rights of Bluestreamme in performing your obligations under any contract.Bluestreamme reserves the right to amend specifications without notice for product improvement.

UNLESS OTHERWISE SPECIFIED: DIMENSIONS ARE IN MILLIMETERS SURFACE FINISH: TOLERANCES:±.5mm LINEAR: ANGULAR:				THIRD ANGLE PROJECTION		DEBURR AND BREAK SHARP EDGES		DO NOT SCALE DRAWING		REVISION: 01	
				CLIENT:		Project Description:					
DRAWN				NAME		SIGNATURE		DATE		Main Contractor:	
CHK'D				CONSULTANT:		TITLE: KAVA II PLANTER					
APPV'D				DWG NO.		A3					
APPV'D				Reference SO NO.:NA		SCALE:1:5		SHEET 1 OF 1			
APPV'D				MFG		Q.A					